

刀架 Holder

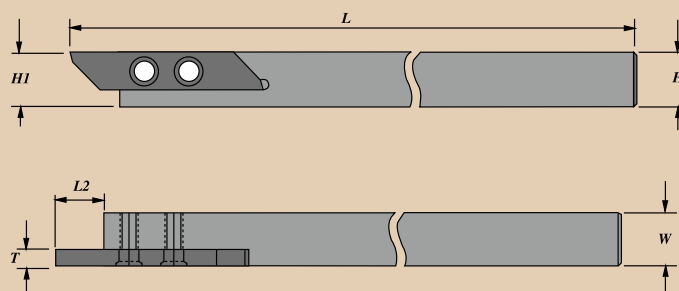

型號 EDP NO.	H=H1	W	L2	L	T	適用刀片 Applicable Inserts
CS 900R/L 1010 H-83	10	10	12	100	3	433.*** 443.***
CS 900R/L 1212 H-83	12	12	12	100	3	
CS 900R/L 1616 H-83	16	16	12	100	3	
CS 900R/L 2020 J-83	20	20	12	110	3	
CS 900R/L 2525 K-83	25	25	12	125	3	
CS 900R/L 1010 H-84	10	10	12	100	4	674.40-** 714.40*** 774.40** 334.40-** 694.40***
CS 900R/L 1212 H-84	12	12	12	100	4	
CS 900R/L 1616 H-84	16	16	12	100	4	
CS 900R/L 2020 J-84	20	20	12	110	4	
CS 900R/L 2525 K-84	25	25	12	125	4	
CS 900R/L 1212 H-85	12	12	12	100	5	714.50***
CS 900R/L 1616 H-85	16	16	12	100	5	
CS 900R/L 2020 J-85	20	20	12	110	5	
CS 900R/L 2525 K-85	25	25	12	125	5	

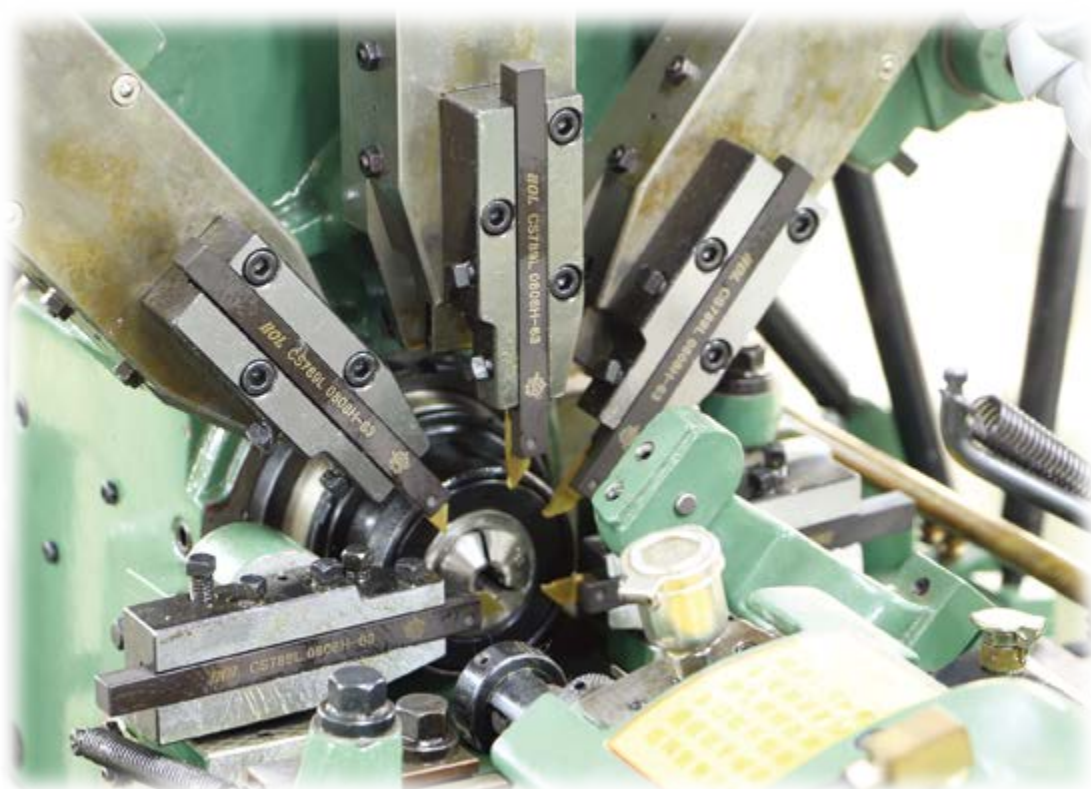

刀架 Holder

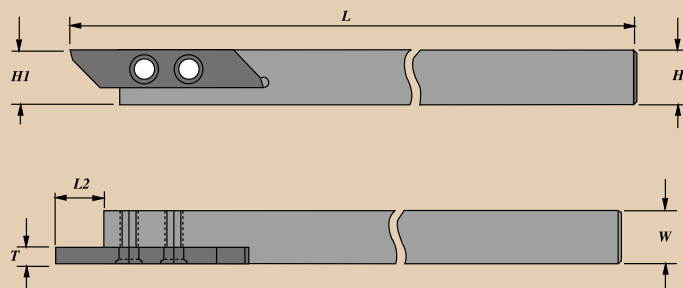

型號 EDP NO.	H=H1	W	L2	L	T	適用刀片 Applicable Inserts
CS 320R/L 1212 J-103	12	12	17	110	3	433.10030-**
CS 320R/L 1616 M-103	16	16	17	150	3	
CS 320R/L 2020 K-103	20	20	17	125	3	
CS 320R/L 2525 M-103	25	25	17	150	3	

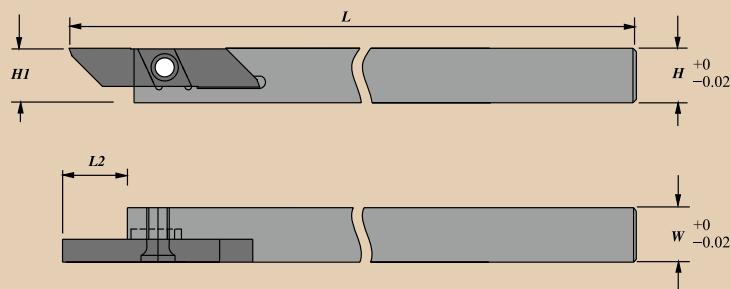

型號 EDP NO.	H=H1	W	L2	L	適用刀片 Applicable Inserts
CS 458R/L 1010 J	10	10	12	110	43.25-** 44.25-**
CS 458R/L 1212 J	12	12	12	110	
CS 458R/L 1616 J	16	16	12	110	
CS 458R/L 2020 K	20	20	12	125	
CS 458R/L 2525 M	25	25	2	150	

刀架 Holder

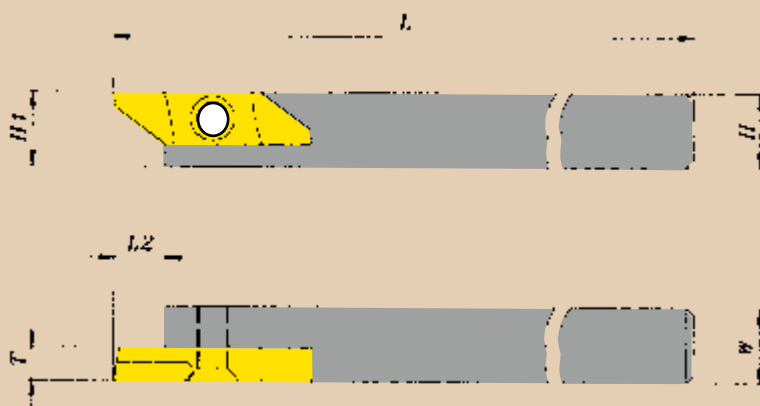

型號 EDP NO.	H=H1	W	L2	L	T	適用刀片 Applicable Inserts
CS 668R/L 1010 H-83	10	10	11	100	3	43.83**
CS 668R/L 1212 H-83	12	12	11	100	3	43.83** 44.83**
CS 668R/L 1616 H-83	16	16	11	100	3	
CS 668R/L 2020 J-83	20	20	11	110	3	
CS 668R/L 2525 K-83	25	25	11	125	3	
CS 668R/L 1010 H-84	10	10	11	100	4	67.84-***
CS 668R/L 1212 H-84	12	12	11	100	4	71.84***
CS 668R/L 1616 H-84	16	16	11	100	4	77.84**
CS 668R/L 2020 J-84	20	20	11	110	4	33.84**
CS 668R/L 2525 K-84	25	25	11	125	4	49.84-***
CS 668R/L 1010 H-85	10	10	11	100	5	69.84-***
CS 668R/L 1212 H-85	12	12	11	100	5	71.85*** 訂製刀片
CS 668R/L 1616 H-85	16	16	11	100	5	
CS 668R/L 2020 J-85	20	20	11	110	5	
CS 668R/L 2525 K-85	25	25	11	125	5	
CS 789R/L 0707 H-63	7	7	9	100	3	
CS 789R/L 0808 H-63	8	8	9	100	3	
CS 789R/L 1010 H-63	10	10	9	100	3	
CS 789R/L 1212 H-63	12	12	9	100	3	
CS 789R/L 1616 H-63	16	16	9	100	3	
CS 789R/L 2020 J-63	20	20	9	110	3	
CS 789R/L 2525 K-63	25	25	9	125	3	
CS 789R/L 0707 H-64	7	7	9	100	4	67.64-*** 71.64-*** 77.64-*** 33.64-*** 69.64-***
CS 789R/L 0808 H-64	8	8	9	100	4	
CS 789R/L 1010 H-64	10	10	9	100	4	
CS 789R/L 1212 H-64	12	12	9	100	4	
CS 789R/L 1616 H-64	16	16	9	100	4	
CS 789R/L 2020 J-64	20	20	9	110	4	
CS 789R/L 2525 K-64	25	25	9	125	4	