

右向切斷刀 Right Hand Part Off

CE 斷屑槽 CE Breaker

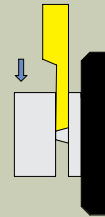
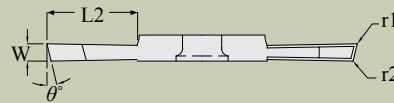
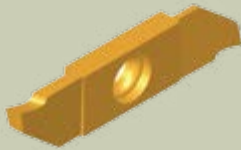

型號 EDP NO.	W	θ°	r1	r2	L2	X21	NC02	HC83	適用刀架 HOLDER NO.
43.6310-00 CE	1.0	15°	0.0	0.0	5		●		CS789R****-63
43.6315-00 CE	1.5	15°	0.0	0.0	8.5	●	●		CS789R****-63
43.6315-005 CE	1.5		0.05	0.05					
43.6315-01 CE	1.5		0.1	0.1					
43.6320-00 CE	2.0	15°	0.0	0.0	8.5	●	●		CS789R****-63
43.6320-005 CE	2.0		0.05	0.05					
43.6320-01 CE	2.0		0.1	0.1					
43.6325-00 CE	2.5	15°	0.0	0.0	8.5	●	●		CS789R****-63
43.6325-005 CE	2.5		0.05	0.05					
43.6325-01 CE	2.5		0.1	0.1					
43.8315-00 CE	1.5	15°	0.0	0.0	8.5	●	●		CS668R****-83
43.8315-005 CE	1.5		0.05	0.05					
43.8315-01 CE	1.5		0.1	0.1					
43.8320-00 CE	2.0	15°	0.0	0.0	10.5	●	●		CS668R****-83
43.8320-005 CE	2.0		0.05	0.05					
43.8320-01 CE	2.0		0.1	0.1					
43.8325-00 CE	2.5	15°	0.0	0.0	10.5	●	●		CS668R****-83
43.8325-005 CE	2.5		0.05	0.05					
43.8325-01 CE	2.5		0.1	0.1					
43.8330-00 CE	3.0	15°	0.0	0.0	10.5	●	●		CS668R****-83
43.8330-005 CE	3.0		0.05	0.05					
43.8330-01 CE	3.0		0.1	0.1					
43.6320-00 WCE	2.0	20°	0.1	0.0	8.5		●		CS789R****-63
43.6320-005 WCE	2.0		0.05	0.05					
43.6320-01 WCE	2.0		0.1	0.1					
43.8320-00 WCE	2.0	20°	0.1	0.0	10.5	●	●		CS668R****-83
43.8320-005 WCE	2.0		0.05	0.05					
43.8320-01 WCE	2.0		0.1	0.1					

無"●"標示者為訂製品。Without "●" marking means custom products.
有"●"標示者為在庫品。With "●" marking means items in stock.

右向切斷刀 Right Hand Part Off

CU 斷屑槽 CU Breaker

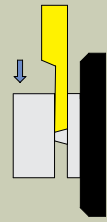
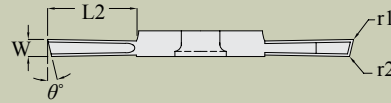
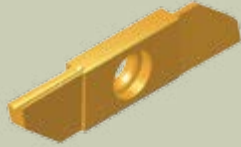

型號 EDP NO.	W	θ°	r1	r2	L2	X21	NC02	HC83	適用刀架 HOLDER NO.
43.6315-00 CU	1.5	15°	0.0	0.0	8.5	●	●		CS789R****-63
43.6315-005 CU	1.5		0.05	0.05					
43.6315-01 CU	1.5		0.1	0.1					
43.6320-00 CU	2.0	15°	0.0	0.0	8.5	●	●		CS789R****-63
43.6320-005 CU	2.0		0.05	0.05					
43.6320-01 CU	2.0		0.1	0.1					
43.6325-00 CU	2.5	15°	0.0	0.0	8.5	●	●		CS789R****-63
43.6325-005 CU	2.5		0.05	0.05					
43.6325-01 CU	2.5		0.1	0.1					
43.8315-00 CU	1.5	15°	0.0	0.0	8.5	●	●		CS668R****-83
43.8315-005 CU	1.5		0.05	0.05					
43.8315-01 CU	1.5		0.1	0.1					
43.8320-00 CU	2.0	15°	0.0	0.0	10.5	●	●		CS668R****-83
43.8320-005 CU	2.0		0.05	0.05					
43.8320-01 CU	2.0		0.1	0.1					
43.8325-00 CU	2.5	15°	0.0	0.0	10.5	●	●		CS668R****-83
43.8325-005 CU	2.5		0.05	0.05					
43.8325-01 CU	2.5		0.1	0.1					
43.8330-00 CU	3.0	15°	0.0	0.0	10.5	●	●		CS668R****-83
43.8330-005 CU	3.0		0.05	0.05					
43.8330-01 CU	3.0		0.1	0.1					
43.6320-00 WCU	2.0	20°	0.1	0.0	8.5	●	●		CS789R****-63
43.6320-005 WCU	2.0		0.05	0.05					
43.6320-01 WCU	2.0		0.1	0.1					
43.8320-00 WCU	2.0	20°	0.1	0.0	10.5	●	●		CS668R****-83
43.8320-005 WCU	2.0		0.05	0.05					
43.8320-01 WCU	2.0		0.1	0.1					

無"●"標示者為訂製品。Without "●" marking means custom products.
 有"●"標示者為在庫品。With "●" marking means items in stock.

右向切斷刀 Right Hand Part Off

CX 斷屑槽 CX Breaker

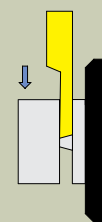
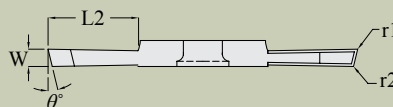

型號 EDP NO.	W	θ°	r1	r2	L2	X21	NC02	HC83	適用刀架 HOLDER NO.
43.6310-00 CX	1.0	15°	0.0	0.0	5		●		CS789R****-63
43.6315-00 CX	1.5	15°	0.0	0.0	8.5	●	●		CS789R****-63
43.6315-005 CX	1.5		0.05	0.05					
43.6315-01 CX	1.5		0.1	0.1					
43.6320-00 CX	2.0	15°	0.0	0.0	8.5	●	●		CS789R****-63
43.6320-005 CX	2.0		0.05	0.05					
43.6320-01 CX	2.0		0.1	0.1					
43.6325-00 CX	2.5	15°	0.0	0.0	8.5	●	●		CS789R****-63
43.6325-005 CX	2.5		0.05	0.05					
43.6325-01 CX	2.5		0.1	0.1					
43.8315-00 CX	1.5	15°	0.0	0.0	8.5	●	●		CS668R****-83
43.8315-005 CX	1.5		0.05	0.05					
43.8315-01 CX	1.5		0.1	0.1					
43.8320-00 CX	2.0	15°	0.0	0.0	10.5	●	●		CS668R****-83
43.8320-005 CX	2.0		0.05	0.05					
43.8320-01 CX	2.0		0.1	0.1					
43.8325-00 CX	2.5	15°	0.0	0.0	10.5	●	●		CS668R****-83
43.8325-005 CX	2.5		0.05	0.05					
43.8325-01 CX	2.5		0.1	0.1					
43.8330-00 CX	3.0	15°	0.0	0.0	10.5	●	●		CS668R****-83
43.8330-005 CX	3.0		0.05	0.05					
43.8330-01 CX	3.0		0.1	0.1					
43.6320-00 WCX	2.0	20°	0.1	0.0	8.5	●	●	●	CS789R****-63
43.6320-005 WCX	2.0		0.05	0.05					
43.6320-01 WCX	2.0		0.1	0.1					
43.8320-00 WCX	2.0	20°	0.1	0.0	10.5	●	●	●	CS668R****-83
43.8320-005 WCX	2.0		0.05	0.05					
43.8320-01 WCX	2.0		0.1	0.1					

無"●"標示者為訂製品。Without "●" marking means custom products.
有"●"標示者為在庫品。With "●" marking means items in stock.

右向切斷刀 Right Hand Part Off

無 斷屑槽 NO Breaker

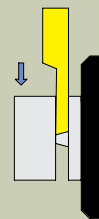
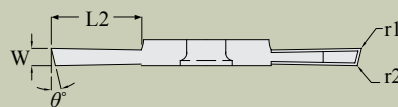
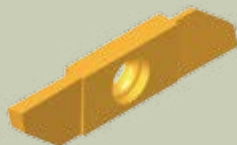

型號 EDP NO.	W	θ°	r1	r2	L2	X21	NC02	HC83	適用刀架 HOLDER NO.
43.6310-00 NB	1.0	15°	0.0	0.0	5	●	●		CS789R****-63
43.6315-00 NB	1.5	15°	0.0	0.0	8.5	●	●		CS789R****-63
43.6315-005 NB	1.5		0.05	0.05		●	●		
43.6315-01 NB	1.5		0.1	0.1		●	●		
43.6320-00 NB	2.0	15°	0.0	0.0	8.5	●	●		CS789R****-63
43.6320-005 NB	2.0		0.05	0.05		●	●		
43.6320-01 NB	2.0		0.1	0.1		●	●		
43.6325-00 NB	2.5	15°	0.0	0.0	8.5	●	●		CS789R****-63
43.6325-005 NB	2.5		0.05	0.05		●	●		
43.6325-01 NB	2.5		0.1	0.1		●	●		
43.8315-00 NB	1.5	15°	0.0	0.0	8.5	●	●		CS668R****-83
43.8315-005 NB	1.5		0.05	0.05		●	●		
43.8315-01 NB	1.5		0.1	0.1		●	●		
43.8320-00 NB	2.0	15°	0.0	0.0	10.5	●	●		CS668R****-83
43.8320-005 NB	2.0		0.05	0.05		●	●		
43.8320-01 NB	2.0		0.1	0.1		●	●		
43.8325-00 NB	2.5	15°	0.0	0.0	10.5	●	●		CS668R****-83
43.8325-005 NB	2.5		0.05	0.05		●	●		
43.8325-01 NB	2.5		0.1	0.1		●	●		
43.8330-00 NB	3.0	15°	0.0	0.0	10.5	●	●		CS668R****-83
43.8330-005 NB	3.0		0.05	0.05		●	●		
43.8330-01 NB	3.0		0.1	0.1		●	●		
43.6320-00 WNB	2.0	20°	0.1	0.0	8.5	●	●	●	CS789R****-63
43.6320-005 WNB	2.0		0.05	0.05		●	●		
43.6320-01 WNB	2.0		0.1	0.1		●	●		
43.8320-00 WNB	2.0	20°	0.1	0.0	10.5	●	●	●	CS668R****-83
43.8320-005 WNB	2.0		0.05	0.05		●	●		
43.8320-01 WNB	2.0		0.1	0.1		●	●		

無"●"標示者為訂製品。Without "●" marking means custom products.
 有"●"標示者為在庫品。With "●" marking means items in stock.

右向切斷刀 Right Hand Part Off

CE 斷屑槽 CE Breaker

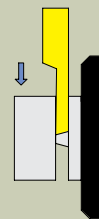
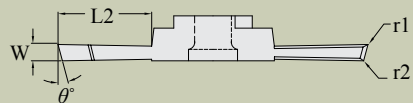

型號 EDP NO.	W	θ°	r1	r2	L2	X21	NC02	UP60	適用刀架 HOLDER NO.
43.2515-00 CE	1.5	15°	0.0	0.0	8.5	●		●	CS458R****
43.2515-01 CE	1.5		0.1	0.1		●		●	
43.2520-00 CE	2.0	15°	0.0	0.0	12	●		●	CS458R****
43.2520-005 CE	2.0		0.05	0.05		●		●	
43.2520-01 CE	2.0		0.1	0.1		●		●	
43.2525-00 CE	2.5	15°	0.0	0.0	14	●		●	CS458R****
43.2525-005 CE	2.5		0.05	0.05		●		●	
43.2525-01 CE	2.5		0.1	0.1		●		●	
43.2530-00 CE	3.0	15°	0.0	0.0	14	●		●	CS458R****
43.2530-005 CE	3.0		0.05	0.05		●		●	
43.2530-01 CE	3.0		0.1	0.1		●		●	
43.2515-00 WCE	1.5	20°	0.0	0.0	8.5	●		●	CS458R****
43.2515-01 WCE	1.5		0.1	0.1		●		●	
43.2520-00 WCE	2.0	20°	0.0	0.0	12	●		●	CS458R****
43.2520-005 WCE	2.0		0.05	0.05		●		●	
43.2520-01 WCE	2.0		0.1	0.1		●		●	
43.2525-00 WCE	2.5	20°	0.0	0.0	14	●		●	CS458R****
43.2525-005 WCE	2.5		0.05	0.05		●		●	
43.2525-01 WCE	2.5		0.1	0.1		●		●	
43.2530-00 WCE	3.0	20°	0.0	0.0	14	●		●	CS458R****
43.2530-005 WCE	3.0		0.05	0.05		●		●	
43.2530-01 WCE	3.0		0.1	0.1		●		●	

無"●"標示者為訂製品。Without "●" marking means custom products.
有"●"標示者為在庫品。With "●" marking means items in stock.

台灣專利 第：M390832號
中國專利 字號：ZL 2009 2 0136227.3
日本專利 實願：2010-005365

右向切斷刀 Right Hand Part Off

CU 斷屑槽 CU Breaker

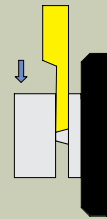
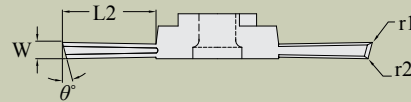

型號 EDP NO.	W	θ°	r1	r2	L2	XZ1	NC02	UP60	適用刀架 HOLDER NO.
43.2515-00 CU	1.5	15°	0.0	0.0	8.5	●		●	CS458R****
43.2515-005 CU	1.5		0.05	0.05		●		●	
43.2515-01 CU	1.5		0.1	0.1		●		●	
43.2520-00 CU	2.0	15°	0.0	0.0	12	●		●	CS458R****
43.2520-005 CU	2.0		0.05	0.05		●		●	
43.2520-01 CU	2.0		0.1	0.1		●		●	
43.2525-00 CU	2.5	15°	0.0	0.0	14	●		●	CS458R****
43.2525-005 CU	2.5		0.05	0.05		●		●	
43.2525-01 CU	2.5		0.1	0.1		●		●	
43.2530-00 CU	3.0	15°	0.0	0.0	14	●		●	CS458R****
43.2530-005 CU	3.0		0.05	0.05		●		●	
43.2530-01 CU	3.0		0.1	0.1		●		●	
43.2515-00 WCU	1.5	20°	0.0	0.0	8.5	●		●	CS458R****
43.2515-005 WCU	1.5		0.05	0.05		●		●	
43.2515-01 WCU	1.5		0.01	0.1		●		●	
43.2520-00 WCU	2.0	20°	0.0	0.0	12	●		●	CS458R****
43.2520-005 WCU	2.0		0.05	0.05		●		●	
43.2520-01 WCU	2.0		0.1	0.1		●		●	
43.2525-00 WCU	2.5	20°	0.0	0.0	14	●		●	CS458R****
43.2525-005 WCU	2.5		0.05	0.05		●		●	
43.2525-01 WCU	2.5		0.1	0.1		●		●	
43.2530-00 WCU	3.0	20°	0.0	0.0	14	●		●	CS458R****
43.2530-005 WCU	3.0		0.05	0.05		●		●	
43.2530-01 WCU	3.0		0.1	0.1		●		●	

無"●"標示者為訂製品。Without "●" marking means custom products.
有"●"標示者為在庫品。With "●" marking means items in stock.

台灣專利 第：M390832號
中國專利 字號：ZL 2009 2 0136227.3
日本專利 實願：2010-005365

本系列專利車刀特性：



1. 刀刃單邊受損可換邊繼續使用，不影響加工效率。

1. In case one side of flute is damaged, user can change to the other side of flute for continuing operation without affecting machining efficiency.



2. 刀刃磨耗後可多次研磨重複使用。使刀刃得到最高的經濟效益。

2. When cutting edge is worn, the insert can be ground for repetitive use to achieve highly economic efficiency.

右向切斷刀 Right Hand Part Off

CX 斷屑槽 CX Breaker

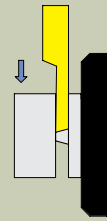
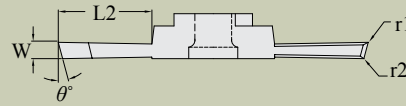

型號 EDP NO.	W	θ°	r1	r2	L2	X21	NC02	UP60	適用刀架 HOLDER NO.
43.2515-00 CX	1.5	15°	0.0	0.0	8.5	●		●	CS458R****
43.2515-005 CX	1.5		0.05	0.05		●		●	
43.2515-01 CX	1.5		0.1	0.1		●		●	
43.2520-00 CX	2.0	15°	0.0	0.0	12	●		●	CS458R****
43.2520-005 CX	2.0		0.05	0.05		●		●	
43.2520-01 CX	2.0		0.1	0.1		●		●	
43.2525-00 CX	2.5	15°	0.0	0.0	14	●		●	CS458R****
43.2525-005 CX	2.5		0.05	0.05		●		●	
43.2525-01 CX	2.5		0.1	0.1		●		●	
43.2530-00 CX	3.0	15°	0.0	0.0	14	●		●	CS458R****
43.2530-005 CX	3.0		0.05	0.05		●		●	
43.2530-01 CX	3.0		0.1	0.1		●		●	
43.2515-00 WCX	1.5	20°	0.0	0.0	8.5	●		●	CS458R****
43.2515-005 WCX	1.5		0.05	0.05		●		●	
43.2515-01 WCX	1.5		0.1	0.1		●		●	
43.2520-00 WCX	2.0	20°	0.0	0.0	12	●		●	CS458R****
43.2520-005 WCX	2.0		0.05	0.05		●		●	
43.2520-01 WCX	2.0		0.1	0.1		●		●	
43.2525-00 WCX	2.5	20°	0.0	0.0	14	●		●	CS458R****
43.2525-005 WCX	2.5		0.05	0.05		●		●	
43.2525-01 WCX	2.5		0.1	0.1		●		●	
43.2530-00 WCX	3.0	20°	0.0	0.0	14	●		●	CS458R****
43.2530-005 WCX	3.0		0.05	0.05		●		●	
43.2530-01 WCX	3.0		0.1	0.1		●		●	

無"●"標示者為訂製品。Without "●" marking means custom products.
有"●"標示者為在庫品。With "●" marking means items in stock.

台灣專利 第：M390832號
中國專利 字號：ZL 2009 2 0136227.3
日本專利 實願：2010-005365



3. 專利設計，刀尖點可最接近工作中心點，縮短校機時間，提升效率。

3. Patent exclusive designed edge-point which can be most close to working center so that shorten the time for machine programming.



4. 專利設計刀桿長度伸縮自如，可適用於各品牌機床。



4. Patented tool holder can be extended as desired, making it suitable for any brand of lathe.

右向切斷刀 Right Hand Part Off

無 斷屑槽 NO Breaker

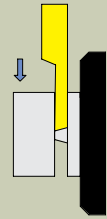
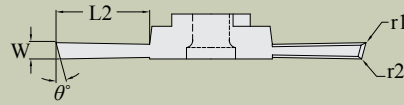

型號 EDP NO.	W	θ°	r1	r2	L2	X21	NC02	UP60	適用刀架 HOLDER NO.
43.2515-00 NB	1.5	15°	0.0	0.0	8.5	●		●	CS458R****
43.2515-005 NB	1.5		0.05	0.05		●		●	
43.2515-01 NB	1.5		0.1	0.1		●		●	
43.2520-00 NB	2.0	15°	0.0	0.0	12	●		●	CS458R****
43.2520-005 NB	2.0		0.05	0.05		●		●	
43.2520-01 NB	2.0		0.1	0.1		●		●	
43.2525-00 NB	2.5	15°	0.0	0.0	14	●		●	CS458R****
43.2525-005 NB	2.5		0.05	0.05		●		●	
43.2525-01 NB	2.5		0.1	0.1		●		●	
43.2530-00 NB	3.0	15°	0.0	0.0	14	●		●	CS458R****
43.2530-005 NB	3.0		0.05	0.05		●		●	
43.2530-01 NB	3.0		0.1	0.1		●		●	
43.2515-00 WNB	1.5	20°	0.0	0.0	8.5	●		●	CS458R****
43.2515-005 WNB	1.5		0.05	0.05		●		●	
43.2515-01 WNB	1.5		0.1	0.1		●		●	
43.2520-00 WNB	2.0	20°	0.0	0.0	12	●		●	CS458R****
43.2520-005 WNB	2.0		0.05	0.05		●		●	
43.2520-01 WNB	2.0		0.1	0.1		●		●	
43.2525-00 WNB	2.5	20°	0.0	0.0	14	●		●	CS458R****
43.2525-005 WNB	2.5		0.05	0.05		●		●	
43.2525-01 WNB	2.5		0.1	0.1		●		●	
43.2530-00 WNB	3.0	20°	0.0	0.0	14	●		●	CS458R****
43.2530-005 WNB	3.0		0.05	0.05		●		●	
43.2530-01 WNB	3.0		0.1	0.1		●		●	

無"●"標示者為訂製品。Without "●" marking means custom products.
有"●"標示者為在庫品。With "●" marking means items in stock.

台灣專利 第：M390832號
中國專利 字號：ZL 2009 2 0136227.3
日本專利 實願：2010-005365

右向切斷刀 Right Hand Part Off

CE 斷削槽 CE Breaker

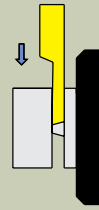
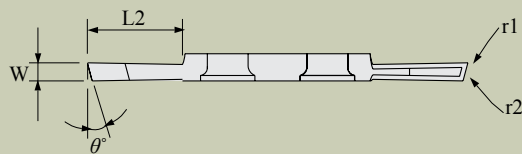

型號 EDP NO.	W	θ°	r1	r2	L2	X21	NA01	HC83	適用刀架 HOLDER NO.
433.10-00 CE	1.0	15°	0.0	0.0	5	●	●		CS900R****83
433.15-00 CE	1.5		0.0	0.0	8.5	●	●		
433.15-005 CE	1.5		0.05	0.05		●	●		
433.15-01 CE	1.5		0.1	0.1		●	●		
433.20-00 CE	2.0		0.0	0.0	11.5	●	●		
433.20-005 CE	2.0		0.05	0.05		●	●		
433.20-01 CE	2.0		0.1	0.1		●	●		
433.25-00 CE	2.5		0.0	0.0		●	●		
433.25-005 CE	2.5		0.05	0.05		●	●		
433.25-01 CE	2.5		0.1	0.1		●	●		
433.30-00 CE	3.0		0.0	0.0		●	●		
433.30-005 CE	3.0		0.05	0.05		●	●		
433.30-01 CE	3.0		0.1	0.1		●	●		
433.20-00 WCE	2.0		20°	0.1	0.0	11.5		●	
433.20-005 WCE	2.0	0.05		0.05					
433.20-01 WCE	2.0	0.1		0.1					

CU 斷屑槽 CU Breaker

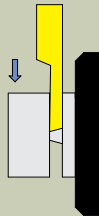
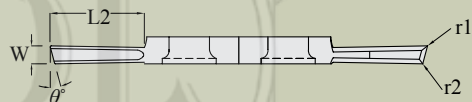
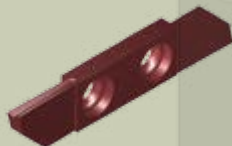

型號 EDP NO.	W	θ°	r1	r2	L2	X21	NA01	HC83	適用刀架 HOLDER NO.		
433.15-00 CU	1.5	15°	0.0	0.0	8.5	●	●		CS900R****83		
433.15-005 CU	1.5		0.05	0.05		●	●				
433.15-01 CU	1.5		0.1	0.1		●	●				
433.20-00 CU	2.0		0.0	0.0	11.5	●	●				
433.20-005 CU	2.0		0.05	0.05		●	●				
433.20-01 CU	2.0		0.1	0.1		●	●				
433.25-00 CU	2.5		0.0	0.0		●	●				
433.25-005 CU	2.5		0.05	0.05		●	●				
433.25-01 CU	2.5		0.1	0.1		●	●				
433.30-00 CU	3.0		0.0	0.0		●	●				
433.30-005 CU	3.0		0.05	0.05		●	●				
433.30-01 CU	3.0		0.1	0.1		●	●				
433.20-00 WCU	2.0		20°	0.1	0.0	11.5	●	●			CS900R****83
433.20-005 WCU	2.0			0.05	0.05						
433.20-01 WCU	2.0	0.1		0.1							

無"●"標示者為訂製品。Without "●" marking means custom products.
有"●"標示者為在庫品。With "●" marking means items in stock.

右向切斷刀 Right Hand Part Off

CX 斷屑槽 CX Breaker

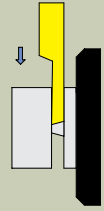
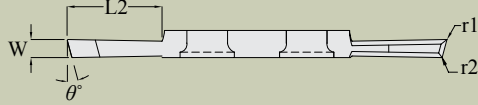
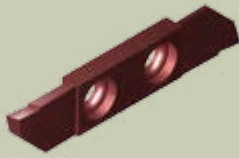

型號 EDP NO.	W	θ°	r1	r2	L2	X21	NA01	HC83	適用刀架 HOLDER NO.
433.10-00 CX	1.0	15°	0.0	0.0	5	•	•		CS900R****83
433.15-00 CX	1.5		0.0	0.0	8.5	•	•		
433.15-005 CX	1.5		0.05	0.05		•	•		
433.15-01 CX	1.5		0.1	0.1		•	•		
433.20-00 CX	2.0		0.0	0.0	11.5	•	•		
433.20-005 CX	2.0		0.05	0.05		•	•		
433.20-01 CX	2.0		0.1	0.1		•	•		
433.25-00 CX	2.5		0.0	0.0	11.5	•	•		
433.25-005 CX	2.5		0.05	0.05		•	•		
433.25-01 CX	2.5		0.1	0.1		•	•		
433.30-00 CX	3.0		0.0	0.0	11.5	•	•		
433.30-005 CX	3.0		0.05	0.05		•	•		
433.30-01 CX	3.0		0.1	0.1		•	•		
433.20-00 WCX	2.0		20°	0.1	0.0	11.5			
433.20-005 WCX	2.0	0.05		0.05					
433.20-01 WCX	2.0	0.1		0.1					

CX 斷削槽 CX Breaker

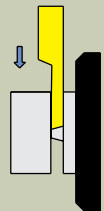
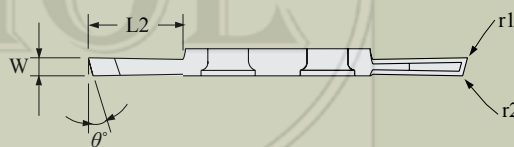
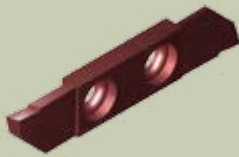

型號 EDP NO.	W	θ°	r1	r2	L2	X21	NA01	HC83	適用刀架 HOLDER NO.
433.10025-00 CX	2.5	15°	0.0	0.0	14		•		CS320R****103
433.10025-01 CX	2.5		0.1	0.1					
433.10030-00 CX	3.0		0.0	0.0	17		•		
433.10030-01 CX	3.0		0.1	0.1			•		

無"•"標示者為訂製品。Without "•" marking means custom products.
 有"•"標示者為在庫品。With "•" marking means items in stock.

右向切斷刀 Right Hand Part Off

無 斷削槽 NO Breaker

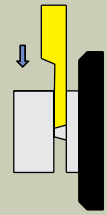
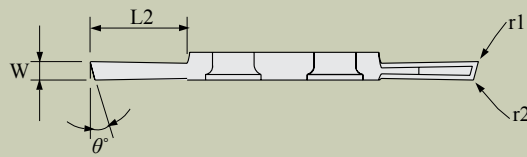
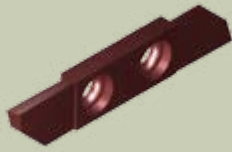

型號 EDP NO.	W	θ°	r1	r2	L2	X21	NA01	HC83	適用刀架 HOLDER NO.
433.10-00 NB	1.0	15°	0.0	0.0	5	●	●		CS900R****83
433.15-00 NB	1.5		0.0	0.0	8.5	●	●		
433.15-005 NB	1.5		0.05	0.05		●	●		
433.15-01 NB	1.5		0.1	0.1		●	●		
433.20-00 NB	2.0		0.0	0.0		●	●		
433.20-005 NB	2.0		0.05	0.05	11.5	●	●		
433.20-01 NB	2.0		0.1	0.1		●	●		
433.25-00 NB	2.5		0.0	0.0		●	●		
433.25-005 NB	2.5		0.05	0.05	11.5	●	●		
433.25-01 NB	2.5		0.1	0.1		●	●		
433.30-00 NB	3.0		0.0	0.0		●	●		
433.30-005 NB	3.0		0.05	0.05	11.5	●	●		
433.30-01 NB	3.0		0.1	0.1		●	●		
433.20-00 WNB	2.0		20°	0.1	0.0	11.5	●		
433.20-005 WNB	2.0	0.05		0.05					
433.20-01 WNB	2.0	0.1		0.1					

無 斷削槽 NO Breaker

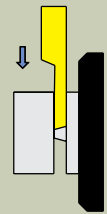
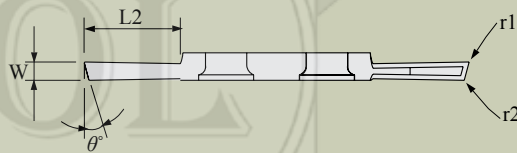
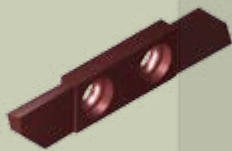

型號 EDP NO.	W	θ°	r1	r2	L2	X21	NA01	HC83	適用刀架 HOLDER NO.
433.10025-00 NB	2.5	15°	0.0	0.0	14	●	●		CS320R****103
433.10025-01 NB	2.5		0.1	0.1					
433.10030-00 NB	3.0		0.0	0.0	17				
433.10030-01 NB	3.0		0.1	0.1					

無"●"標示者為訂製品。Without "●" marking means custom products.
有"●"標示者為在庫品。With "●" marking means items in stock.