

SC-61系列 SC-61 SERIES

替換型高速中負荷迴轉頂針 Interchangeable High Speed Medium Duty Live Center

用途：

本頂針適合300 m/m長以內一般車削加工，本頂針軸承，徑向力和軸向力分開設計，採用雙列滾珠軸承、滾珠止推軸承，和NK型滾針軸承結構製成。

Application:

The series of live center is suitable for turning workpiece length within 300mm. The bearings in the live center provide separated radial and axial resistant force. The bearings consist of double-row ball bearing, thrust ball bearing and NK type needle bearing.

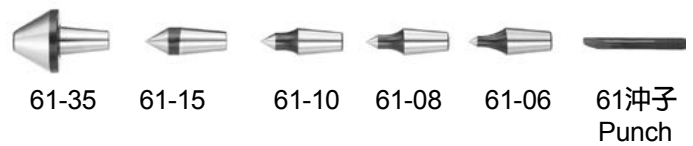
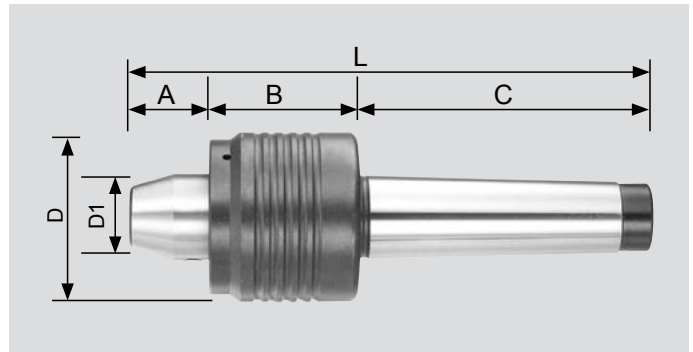

尺寸表 DIMENSIONS

精準度：0.008m/m內
Accuracy: within 0.008m/m

型式/外表尺寸 Model / Size	MT	A	B	C	D	D1	L	軸承最高轉數 Max. Bearing Speed	軸承徑向力 Bearing Radial Force	軸承軸向力 Bearing Axial Force
SC-61-M-3	3	30	55	90.5	64	32.4	175.5	4500.rpm	1300kg	2250kg
SC-61-M-3-A	3	30	72	90.5	64	32.4	187.5	4500.rpm	1300kg	2250kg
SC-61-M-4	4	30	55	108	64	32.4	193	4500.rpm	1300kg	2250kg
SC-61-M-4A	4	30	72	108	64	32.4	205	4500.rpm	1300kg	2250kg
SC-61-M-5	5	30	55	135	64	32.4	220	4500.rpm	1300kg	2250kg
SC-61-M-5A	5	30	72	135	64	32.4	232	4500.rpm	1300kg	2250kg

單位/Unit : mm

SC-62系列 SC-62 SERIES

固定型重負荷迴轉頂針 Fixed Heavy Duty Live Center

用途：

本頂針適合400 m/m長以內一般車削加工。

Application:

The series of live center is suitable for turning workpiece length within 400mm.

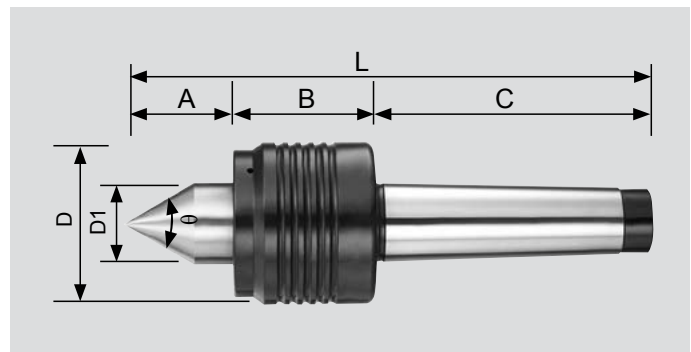

尺寸表 DIMENSIONS

精準度：0.008m/m內
Accuracy: within 0.008m/m

型式/外表尺寸 Model / Size	MT	A	B	C	D	D1	L	θ	軸承最高轉數 Max. Bearing Speed	軸承徑向力 Bearing Radial Force	軸承軸向力 Bearing Axial Force
SC-62-H-4	4	45	56	108	68	32.4	209	60°	4000.rpm	1420kg	2760kg
SC-62-H-4-A	4	45	73	108	68	32.4	221	60°	4000.rpm	1420kg	2760kg
SC-62-H-5	5	45	56	135	68	32.4	236	60°	4000.rpm	1420kg	2760kg
SC-62-H-5A	5	45	73	135	68	32.4	248	60°	4000.rpm	1420kg	2760kg

單位/Unit : mm